

# CELEBRATE OUR ONE YEAR ANNIVERSARY

HOTEL INDIGO® DOWNTOWN LOS ANGELES GROUP OFFER



## Book your group before the end of February and receive:

|                     |                  |
|---------------------|------------------|
| \$10,000 – \$20,000 | = Select 1 Perk  |
| \$20,000 - \$30,000 | = Select 2 Perks |
| \$30,000 - \$40,000 | = Select 3 Perks |
| Over \$40,000       | = Select 4 Perks |

- 3% Off Master Bill
- Accelerated Comp Policy (1 per 35)
- Double IHG Reward Points for Meeting Planner
- 1-Night Complimentary Stay Certificate
- \$250 Visa Gift Card
- Complimentary AM or PM Break
- Complimentary Guest Room WiFi
- 3% Rebate on Food & Beverage (excl. tax & svc)
- Waive 1-Bartender or 1-Station Attendant Fee
- 1-Upgrade to Executive Suite
- Complimentary Standard A/V Support Package

### DOUBLE YOUR PERKS FOR SELECT DATES IN Q3

Group or Event must be booked by 2/28/2018. Group or Event must be actualized by 12/31/2018.  
Blackout dates to apply.



# Let Us Be Your Canvas

Our inspired spaces, with vaulted 16ft ceilings and warm natural light, will bring out the best your group has to offer.

Take advantage of our distinctive indoor-outdoor event venues to bring people together and stimulate new thinking.

Our unique activity and break packages, exceptional cuisine and neighborhood connections will encourage teambuilding and spur your success.

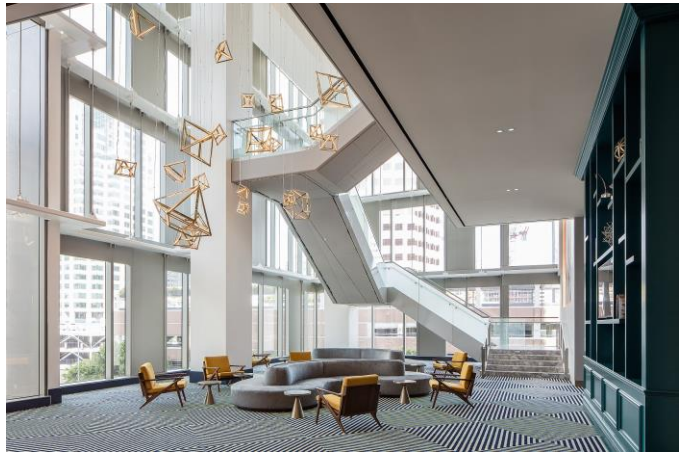

## Meeting Facilities

- 12 Meeting Rooms - 9 with floor-to-ceiling windows
- Meet/Eat 200+ in classroom with 8 breakouts
- Unique indoor/outdoor entertainment suites with firepits
- Outdoor terrace rooftop space for up to 500 people
- Total Area of Meeting Space: 22,343 sq. ft.
- 1.5 Gigabit scale-able/route-able wifi

| MEETING & FUNCTION SPACE                              |    |    |       |           | CAPACITY |     |      |     |     |    |
|---|----|----|-------|-----------|----------|-----|------|-----|-----|----|
| 3 <sup>RD</sup> FLOOR                                 | L  | W  | CL HT | UNIT (SF) | CS       | THR | CONF | REC | BQT | U  |
| Orpheum Ballroom A & B                                | 70 | 55 | 16    | 3,850     | 220      | 350 | 100  | 350 | 240 | 84 |
| Orpheum Ballroom A                                    | 35 | 55 | 16    | 1,925     | 100      | 170 | 50   | 175 | 120 | 42 |
| Orpheum Ballroom B                                    | 35 | 55 | 16    | 1,925     | 100      | 170 | 50   | 175 | 120 | 42 |
| Pre-Function Area                                     |    |    | 16    | 2,026     | 0        | 0   | 0    | 300 | 160 | 34 |
| Metropolitan  | 54 | 36 | 16    | 1,970     | 112      | 155 | 55   | 180 | 150 | 55 |
| Empire Board Room                                     | 34 | 21 | 14    | 717       | --       | --  | 12   | --  | --  | 10 |
| Tivoli  | 25 | 30 | 14    | 754       | 50       | 74  | 16   | 75  | 40  | 14 |
| Belasco   | 23 | 41 | 14    | 942       | 62       | 115 | 24   | 100 | 70  | 25 |
| 4 <sup>TH</sup> FLOOR                                 |    |    |       |           |          |     |      |     |     |    |
| Palace + Olympic + Globe                              | 22 | 72 | 14    | 1,472     | 72       | 150 | 40   | 170 | 90  | -- |
| Palace  | 22 | 30 | 14    | 574       | 30       | 60  | 16   | 70  | 40  | 10 |
| Olympic   | 22 | 27 | 14    | 582       | 30       | 60  | 16   | 70  | 40  | 10 |
| Globe   | 22 | 15 | 14    | 316       | 12       | 30  | 8    | 30  | 10  | 5  |
| Regent Board Room                                     | 25 | 30 | 14    | 731       | --       | --  | 12   | --  | --  | 10 |
| Hollander   | 34 | 21 | 14    | 700       | 50       | 74  | 16   | 75  | 40  | 14 |
| Total Meeting & Function Space                        |    |    |       | 11,137    |          |     |      |     |     |    |
| Total Meeting & Function Space with Pre-Function Area |    |    |       | 13,163    |          |     |      |     |     |    |
| LOUNGE & OUTDOOR EVENT SPACE                          |    |    |       |           | CAPACITY |     |      |     |     |    |
|   | L  | W  | CL HT | UNIT (SF) | REC      |     |      |     |     |    |
| Total Terrace   |    |    |       | 1,310     | 150      |     |      |     |     |    |
| Palace Terrace  |    |    |       | 390       | 40       |     |      |     |     |    |
| Olympic Terrace                                       |    |    |       | 470       | 45       |     |      |     |     |    |
| Globe Terrace   |    |    |       | 450       | 45       |     |      |     |     |    |
| Pool Deck (4th Floor)                                 |    |    |       | 4,260     | 213      |     |      |     |     |    |
| 18 Social (18th Floor)                                |    |    | 10    | 3,610     | 150      |     |      |     |     |    |
| Subtotal  |    |    |       | 9,180     |          |     |      |     |     |    |
| Total Meeting, Function, and Outdoor Event Space      |    |    |       | 20,317    |          |     |      |     |     |    |
| Total Meeting, Event Space with Pre-function Area     |    |    |       | 22,343    |          |     |      |     |     |    |